

REASSEMBLY

1. INSTALL BULB

- (a) Install the bulb to the A/C control panel.
- (b) Using a screwdriver, turn the bulb to the right and lock the bulb.

2. INSTALL A/C AMPLIFIER

- (a) Hold the connector of supply parts amplifier and pull out the amplifier from electrostatic prevention bag.

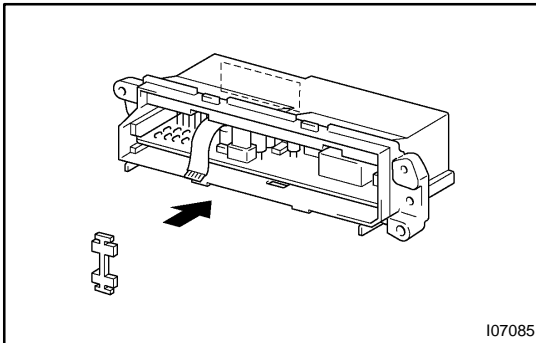

- (b) Hold the connector of amplifier and insert the amplifier to the A/C control panel case.
- (c) Install the holder.
- (d) Check the fitting for connector of amplifier.

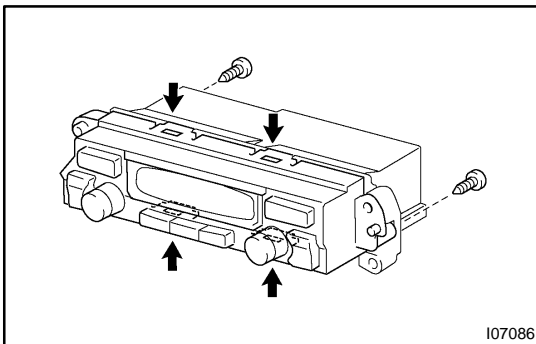

3. INSTALL A/C CONTROL PANEL

- (a) Unlock the connector's lock and push into the flat cable.
- (b) Install the A/C control panel.
- (c) Check the fitting for 4 claws.
- (d) Install the 2 screws.